

FACILITY SPECIFICATIONS

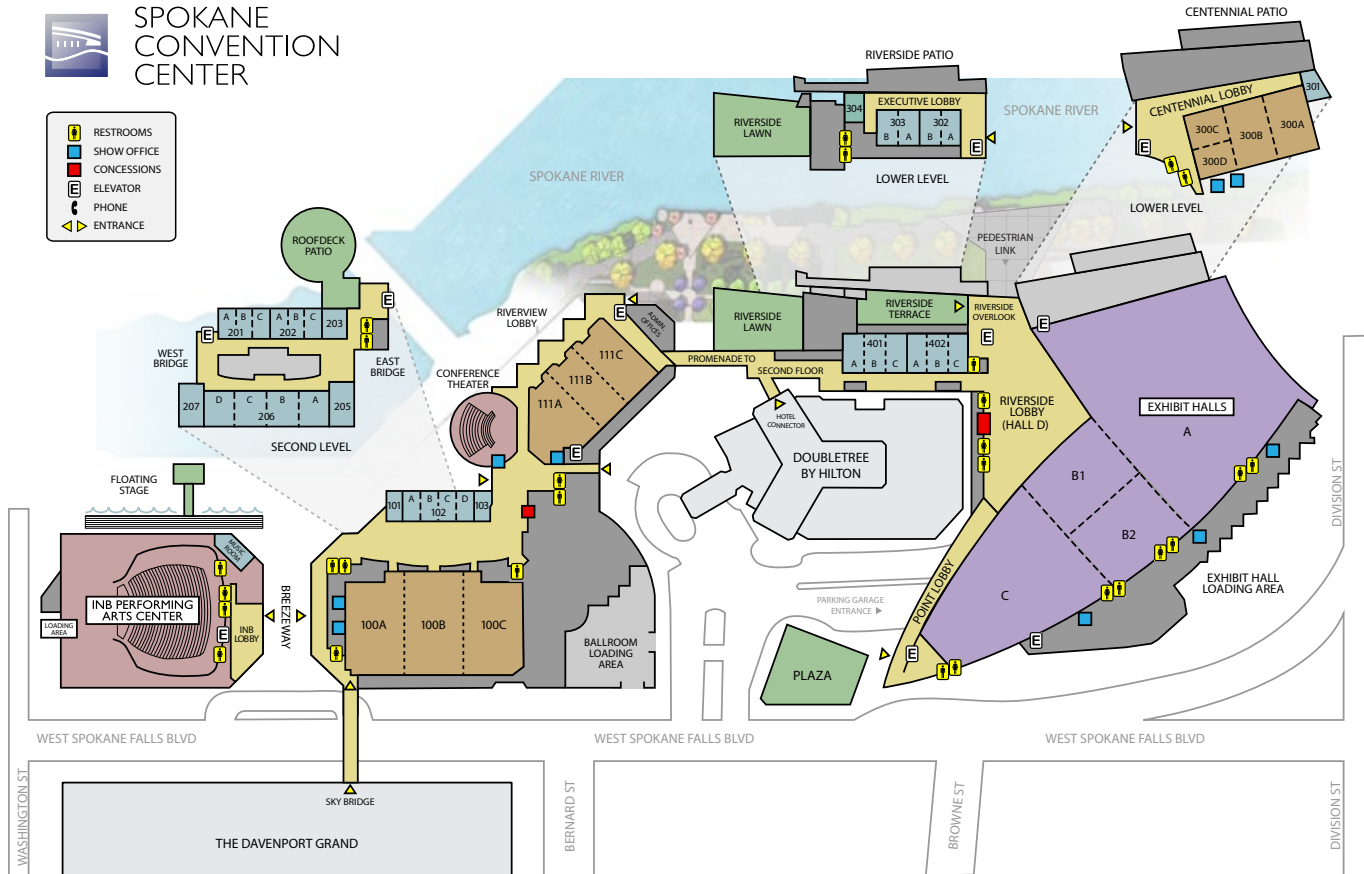

**SPOKANE
CONVENTION
CENTER**



KEY:	EXHIBIT HALLS	BALLROOMS	MEETING ROOMS	BOARDROOM	THEATERS	LOBBIES	OUTSIDE SPACE
------	---------------	-----------	---------------	-----------	----------	---------	---------------

EXHIBIT HALLS								
ROOM NUMBER	SQUARE FOOTAGE	DIMENSIONS	CEILING HEIGHT	BANQUET	THEATER	CLASSROOM	RECEPTION	10X10 BOOTHS
HALL A	53,470	210 x 247	30	3,508	4,463	3,000	4,463	283
HALL B	21,790	120 x 180	30	1,430	3,063	1,200	3,063	117
HALL B1	10,529	80 x 116	30	715	1,531	600	1,531	51
HALL B2	11,240	80 x 116	30	715	1,531	600	1,531	51
HALL C	27,510	130 x 210	30	1,817	3,894	1,600	3,894	130
HALL D (RIVERSIDE)	20,000	-	22	954	-	-	2,045	-
HALL ABCD	120,000	-	30	7,709	9,750	5,800	12,556	515

LIGHTING		LOADING AND ACCESS CONTINUED							
<ul style="list-style-type: none"> Luminaries are low bay type with reflectors Clustered with (2) 750W metal-halide and (1) 750W incandescent Metal-halide are NOT instant 'on' (5 minute warm-up) Controls allow 'dim' to 'off' positions Max. illumination - approx 10-15 foot candle 		<table border="1"> <tr> <td>HALL C</td> <td> <ul style="list-style-type: none"> Roll-up Door #10: 20'0" W x 15'5" H </td> </tr> <tr> <td>ACCESS RAMP (LOADING DOCK)</td> <td> <ul style="list-style-type: none"> Roll-up Door #14: 30'0" W x 14'6" H </td> </tr> <tr> <td>BAYS (LOADING DOCK)</td> <td> <ul style="list-style-type: none"> Roll-up Door #16-23: 9'0" W x 10'0" H Dock Height: 4'0" </td> </tr> </table>		HALL C	<ul style="list-style-type: none"> Roll-up Door #10: 20'0" W x 15'5" H 	ACCESS RAMP (LOADING DOCK)	<ul style="list-style-type: none"> Roll-up Door #14: 30'0" W x 14'6" H 	BAYS (LOADING DOCK)	<ul style="list-style-type: none"> Roll-up Door #16-23: 9'0" W x 10'0" H Dock Height: 4'0"
HALL C	<ul style="list-style-type: none"> Roll-up Door #10: 20'0" W x 15'5" H 								
ACCESS RAMP (LOADING DOCK)	<ul style="list-style-type: none"> Roll-up Door #14: 30'0" W x 14'6" H 								
BAYS (LOADING DOCK)	<ul style="list-style-type: none"> Roll-up Door #16-23: 9'0" W x 10'0" H Dock Height: 4'0" 								
LOADING AND ACCESS MAIN EXHIBIT HALL ACCESS DOORS		MAIN EXHIBIT HALL LOADING DOCK							
HALL A	<ul style="list-style-type: none"> Roll-up Door #26: 25'4" W x 20'0" H Roll-up Door #25: 18'6" W x 20'0" H Roll-up Door #24: 15'6" W x 15'0" H Roll-up Door #12: 15'6" W x 14'0" H 	<ul style="list-style-type: none"> Entrance off Division Street (gate 6 - 16'6" wide) 8 bays, 4 with vehicle restraint systems Each bay has a roll-up door - 8'0" W x 10'0" H (dock height 4'0") Exit gate (23'0" wide) 							
HALL B	<ul style="list-style-type: none"> Roll-up Door #11: 19'11" W x 15'5" H 	SMALL TRUCK LOADING DOCK							
		<ul style="list-style-type: none"> Entrance off Spokane Falls Blvd (gate 4 - 22'0" wide opening) Freight elevator to marshalling area 							

BALLROOMS

ROOM NUMBER	SQUARE FOOTAGE	DIMENSIONS	CEILING HEIGHT	BANQUET	THEATER	CLASSROOM	RECEPTION	10X10 BOOTHS
100A	8,094	71 x 114	12 - 24	530	840	456	900	37
100B	9,088	71 x 128	12 - 24	570	900	520	900	43
100C	8,094	71 x 114	12 - 24	530	830	456	900	37
100ABC	25,276	-	12 - 24	1,630	2,525	1,483	2,700	131
111A	4,990	71 x 88	17 - 24	304	450	244	525	20
111B	4,224	48 x 88	17 - 24	296	437	236	475	22
111C	4,224	48 x 88	17 - 24	296	437	236	475	22
111ABC	13,438	-	17 - 24	896	1,320	752	1,475	71
300A	3,865	78 x 48	20	265	374	230	500	16
300B	3,985	78 x 50	20	265	374	230	500	16
300C	2,027	42 x 48	20	133	186	115	250	8
300D	1,939	39 x 48	20	133	186	115	250	8
300ABCD	11,816	78 x 150	20	796	1120	690	1,500	54

LIGHTING	LOADING AND ACCESS
<p>GRAND BALLROOM (100 A, B, C)</p> <ul style="list-style-type: none"> Primary lighting is 150W metal-halide down lights Secondary lighting is dimmed 150 W incandescent down lights Controls allow 'dim' to 'off' positions Max. illumination - approx 75 to 80 foot candles <p>111 BALLROOM (111 A, B, C)</p> <ul style="list-style-type: none"> Several lighting arrangements are possible Contact your Event Manager for details <p>300 BALLROOM (300 A, B, C, D)</p> <ul style="list-style-type: none"> LED accent lighting (custom color) Several lighting arrangements are possible Contact your Event Manager for details 	<p>GRAND BALLROOM (100 A, B, C)</p> <ul style="list-style-type: none"> Two sets of double doors to each ballroom - 7'0"W x 8'0"H Ballroom 100C roll-up door - 12' W x 12' H <p>111 BALLROOM (111 A, B, C)</p> <ul style="list-style-type: none"> One set of double doors to each ballroom - 5'6"W x 6'11"H Ballroom 100C roll-up door - 8' W x 12' H <p>300 BALLROOM (300 A, B, C, D)</p> <ul style="list-style-type: none"> One set of doors with service access - 35 1/2"W x 6'11"H Double doors access to lobby via turnabout 9'9" wide

MEETING ROOMS

ROOM NUMBER	SQUARE FOOTAGE	DIMENSIONS	CEILING HEIGHT (FT)	BANQUET	THEATER	CLASSROOM	RECEPTION
101	533	20.5 x 26	12	40	50	32	50
102A	533	20.5 x 26	12	40	50	32	50
102B	533	20.5 x 26	12	40	50	32	50
102C	533	20.5 x 26	12	40	50	32	50
102D	533	20.5 x 26	12	40	50	32	50
103	568	35.5 x 13	10	40	50	32	50
201A	533	20.5 x 26	9.5	40	50	32	50
201B	533	20.5 x 26	9.5	40	50	32	50
201C	533	20.5 x 26	9.5	40	50	32	50
202A	533	20.5 x 26	9.5	40	50	32	50
202B	533	20.5 x 26	9.5	40	50	32	50
202C	533	20.5 x 26	9.5	40	50	32	50
203	741	28.5 x 26	9.5	48	67	40	75
205	1,450	29 x 50	10	80	150	80	160
206A	1,369	37 x 37	10	88	145	80	160
206B	1,369	37 x 37	10	88	145	80	160
206C	1,369	37 x 37	10	88	145	80	160

MEETING ROOMS

ROOM NUMBER	SQUARE FOOTAGE	DIMENSIONS	CEILING HEIGHT (FT)	BANQUET	THEATER	CLASSROOM	RECEPTION
206D	1,369	37 x 37	10	88	145	80	160
207	1,450	29 x 50	10	80	150	80	160
301	760	-	9.5	49	49	49	49
302A	1,015	24 x 41	14	66	100	66	142
302B	1,016	24 x 41	14	66	100	66	142
303A	1,016	24 x 41	14	66	100	66	142
303B	1,015	24 x 41	14	66	100	66	142
401A	1,005	39 x 24	14	60	100	56	137
401B	1,018	39 x 25	14	66	100	66	141
401C	1,028	39 x 25	14	66	100	66	141
402A	1,028	39 x 25	14	66	100	66	142
402B	1,028	39 x 25	14	66	100	66	141
402C	1,018	39 x 25	14	63	100	66	135

LIGHTING AND OTHER AMENITIES

<p>MEETING ROOMS (101, 102 A-D, 103)</p> <ul style="list-style-type: none"> 4 Banks of 4 Florescent Fixtures 3 Banks of 4 Dimmable Cans Each Room contains a wet bar with a 4-way outlet <ul style="list-style-type: none"> Each Room contains audio, floor and wall outlets, phone jacks and microphone jack North facing rooms with a window wall, curtains for darkening <p>MEETING ROOMS (205 - 207)</p> <ul style="list-style-type: none"> Florescent fixtures with dimming ballasts <p>MEETING ROOMS (201A - 203)</p> <ul style="list-style-type: none"> 4 Banks of 4 Florescent Fixtures 3 Banks of 4 Dimmable Cans <ul style="list-style-type: none"> Each Room contains a wet bar with a 4-way outlet Each Room contains audio, floor and wall outlets, phone jacks and microphone jack North facing rooms with a window wall, curtains for darkening Slider (4'11" W x 9' H) opens to deck with rail (5' 6" wide) 	<p>MEETING ROOMS (302 - 303)</p> <ul style="list-style-type: none"> 2 Banks of 4 dimmable florescent fixtures per room 2 Banks of 5 dimmable cans per room Each room contains audio, video (HDMI, VGA, coax), RJ45, floor and wall outlets, phone and microphone Each room contains one projector <ul style="list-style-type: none"> Wireless assisted hearing device capable Secure area option (when used with entire Executive Wing) <p>MEETING ROOMS (401 ABC - 402 ABC)</p> <ul style="list-style-type: none"> 2 Banks of 4 dimmable florescent fixtures per room 2 Banks of 5 dimmable cans per room Each room contains audio, video (HDMI, VGA, coax), RJ45, floor and wall outlets, phone and microphone Each room contains one projector Wireless assisted hearing device capable <ul style="list-style-type: none"> North facing rooms with a window wall, curtains for darkening
--	---

LOADING AND ACCESS

ROOM NUMBER	DOOR DIMENSIONS
101 - 102D	6' W x 6' H Double (no post)
103	6' W x 6' H Double (no post)
201A - 203	6' W x 6' H Double (no post)
205 - 207	6' W x 6' H Double (no post)
302 - 303	5'7" W x 8' H Double (post) 5' 9" W x 8'0" H Loading to Service 8'0" W x 8'0" H Roll-up Door to Service
401 - 402	5'7" W x 8' H Double (post) 35" W x 8'0" H Single to Terrace Access to Exhibit Hall Loading

NOTE: All access routes/doors are NOT listed above. For specific access routes and door questions please ask your Event Manager or call 509.279.7007 with questions. We are able to accommodate almost all move-in/out requests and thrive on finding solutions for you and your special event requirements.

BOARDROOM

ROOM NUMBER	SQUARE FOOTAGE	CEILING HEIGHT	RECEPTION (BOARD STYLE)
304	805	-	49 (30)

LIGHTING AND OTHER AMENITIES

- Five banks of 3 dimmable can lights
- Fireplace
- Two LCD monitors
- Contains audio, video (HDMI, VGA), floor, table and wall outlets, and cable outlets
- North facing floor-to-ceiling curtained windows with views of the river
- Seating for 16 at the table, additional pocket seating

LOADING AND ACCESS

- Single door access to room (2) - 34 1/2"
- Service/loading access via service area double door 72" W (no post)
- Loading via service corridor roll-up door 8' W x 9' H

THEATERS

ROOM NAME	SQUARE FOOTAGE	DIMENSIONS	CEILING HEIGHT (FT)	BANQUET	THEATER	CLASSROOM	RECEPTION
CONF. THEATER	5,782	-	17 - 24	-	270	-	-

INB PERFORMING ARTS CENTER

AUDITORIUM	90,560	-	-	-	2,683	-	-
MUSIC ROOM	2,500	136 x 64	15.5	150	200	150	200
LOBBY	-	-	-	-	-	-	700

LIGHTING

CONFERENCE THEATER

- Tiered theater-style seating for 270
- Dimmable lighting
- Stage with screen and projector
- Contains audio, floor and wall outlets, microphone jacks and cable outlets

INB PERFORMING ARTS CENTER

- Tiered theater-style seating for 2,680
- Lighting options based on event type and need
- Lobby areas perfect for pre/post-function events
- For more detailed information please visit INBPAC.com or call 509.327.7007

LOADING AND ACCESS

CONFERENCE THEATER

- Double door 35 1/2" W x 6'11" H
- Access via Ballroom loading area - Gate #2 (30' 8")
- Roll-up door #6 (19' W x 20' H)
- Roll-up door #7 (12'2" W x 13'6" H)

INB PERFORMING ARTS CENTER

- Small access via several convenient doors
- Three truck loading bays with doors (8' W x 10' H)
- For more detailed information please visit INBPAC.com or call 509.327.7007

LOBBIES

LOBBY NAME	SQUARE FOOTAGE	CEILING HEIGHT (FT)	RECEPTION
BALLROOM LOBBY	7,000	26	500
CONFERENCE THEATER	4,200	-	300
THE POINT LOBBY	5,800	-	350
RIVERSIDE LOBBY (HALL D)	20,000	22	2,045
RIVERSIDE OVERLOOK	2,506	-	-
RIVERVIEW LOBBY	5,180	-	-
CENTENNIAL LOBBY	9,240	-	-

The Spokane Convention Center lobbies are great locations for pre/post-function, registration, or breakout events. The lobbies vary in size and location, for specific questions please call 509.279.7007.

OUTSIDE SPACES

OUTSIDE SPACE NAME	SQUARE FOOTAGE	ROUNDS	RECEPTION
ROOF DECK	7,173	260	350
RIVERSIDE EVENT LAWN	9,200	520	650
RIVERSIDE TERRACE	5,230	250	300
RIVERSIDE PATIO	3,000	-	200

GENERAL INFORMATION

The Spokane Convention Center outside spaces are great locations for a variety of events looking to experience the beauty of nature. Breathtaking views of the river and Riverfront park offer the perfect backdrop for receptions, weddings, parties, and banquets. If you have specific questions please call 509.279.7007.

LOADING AND ACCESS

<p>ROOF DECK</p> <ul style="list-style-type: none"> Double door 4'11" W x 6'11" H (two sets) Additional access via room 203: 4'11" W x 8'0" H <p>PLAZA, BREEZEWAY, AND RIVERSIDE PATIO</p> <ul style="list-style-type: none"> All street level, access via turn outs or roundabouts <p>RIVERSIDE TERRACE</p> <ul style="list-style-type: none"> Double door from Riverside Overlook 34 1/2" W each Single door access from 401/402: 35" W Additional access via Terrace staircase to Riverside Lawn 	
--	--

QUESTIONS

Our vision is to provide world-class service and create truly memorable events. We know each event is special and unique; we thrive on the challenge of the new and different. Let us show you how remarkable your event can be at the Spokane Convention Center! Call us today with any questions - 509.279.7007.

Uniquely Urban, Spectacularly Spokane.